



## 11 Morrisey Way Rouse Hill NSW

4  3  2 

Tucked away in a whisper quiet locale with lush bush views, this generous family residence is exceptional right from its impressive street presence. Spread over a clever dual-level design, the floorplan features an abundance of living and entertaining space to suit growing families. Enjoy spending time with guests by the fireplace in the formal living and dining zone, or relaxing in the cosy, sunken living room. A home theatre and games room on the lower level make entertaining a breeze. The statement kitchen is large in size, features plenty of bench space and modern stainless-steel cooking appliances. The family zone opens to a covered decking ideal for alfresco dining while relishing the landscaped backyard.

Formal accommodation is comprised of four well-sized bedrooms on the upper level with integrated storage included in each. The master suite is a sanctuary for busy

**Land Size** : 763 sqm  
**View** : <https://www.guardianrealty.com.au/sale/nsw/hills/rouse-hill/residential/house/8001032>



**Joel Green**  
0408 293 262



**Ben Chetcuti**  
0475 909 787

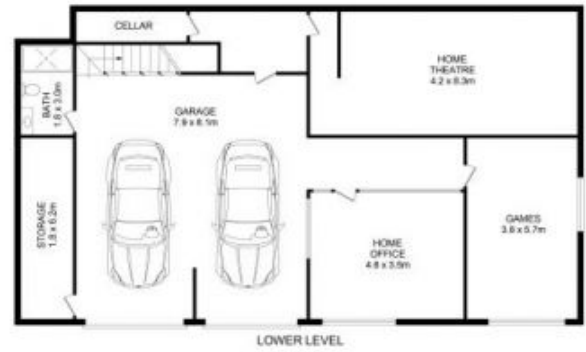

## 11 Morrisey Way, Rouse Hill

### Disclaimer

Floor Plan measurements are approximate and are for illustrative purposes only. While we cannot doubt the floor plans accuracy, we make no guarantee, warranty or representation as to the accuracy and completeness of the floor plan

