



### 15 Sherwin Avenue Castle Hill NSW

3  1  1 

Enviably located right in the heart of Castle Hill, this rectangular-shaped parcel and neat residence with an 18.2m frontage boasts incredible potential. Enjoying position on the high-side of the street, the existing home boasts light-filled living and dining spaces. Caesarstone benchtops frame the renovated kitchen which includes stainless-steel cooking appliances, ample bench space and plenty of storage. The rear covered pergola area overlooks the child and pet-friendly backyard.

Formal accommodation consists of three well-sized bedrooms with built-in storage included in the master suite and second bedroom. Choose to make the address home or capitalise on the R4 high density zoning. This ultra-convenient address is a short stroll to Castle Towers, Castle Hill metro station and bus interchange.

**Price** : \$ 2,000,000  
**Land Size** : 733 sqm  
**View** : <https://www.guardianrealty.com.au/sale/nsw/hills/castle-hill/residential/house/7676398>



**Grant McEnally**  
0414 968 460



**Benjamin See**  
0410 264 809

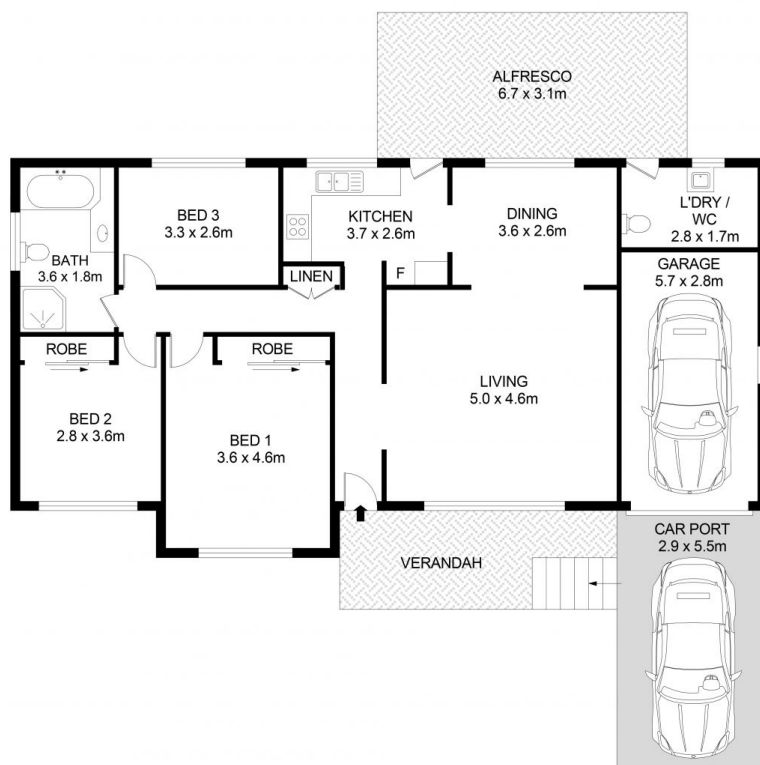
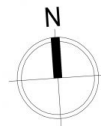

SITE PLAN  
(NOT TO SCALE)

## 15 Sherwin Avenue, Castle Hill



### Disclaimer

Floor Plan measurements are approximate and are for illustrative purposes only. While we cannot doubt the floor plans accuracy, we make no guarantee, warranty or representation as to the accuracy and completeness of the floor plan

