



31 Janamba Avenue Kellyville NSW

3  1  2 

Peacefully positioned within a leafy Kellyville pocket, this renovated home is an ideal family starter or downsizer. Tastefully refreshed throughout, the home boasts sun-soaked living spaces and a huge rear yard. Caesarstone benchtops frame the beautifully renovated kitchen which overlooks the backyard, has plenty of storage and modern stainless-steel cooking appliances. Glass sliders from the dining zone open to an elevated alfresco ideal for entertaining family and friends.

Three well-sized bedrooms with built-in storage make up the formal accommodation. A deluxe main bathroom featuring floor-to-ceiling tiles and a gorgeous free-standing tub serves the home. This family-friendly address is within walking distance to buses, parks, Kellyville Public School and Our Lady Of The Rosary Primary School. It's also only a short drive from Castle Towers, Rouse Hill Town Centre

Price : \$ 1,432,000
Land Size : 696 sqm
View : <https://www.guardianrealty.com.au/sale/nsw/hills/kellyville/residential/house/7220557>



Joel Green
0408 293 262



Ben Chetcuti
0475 909 787

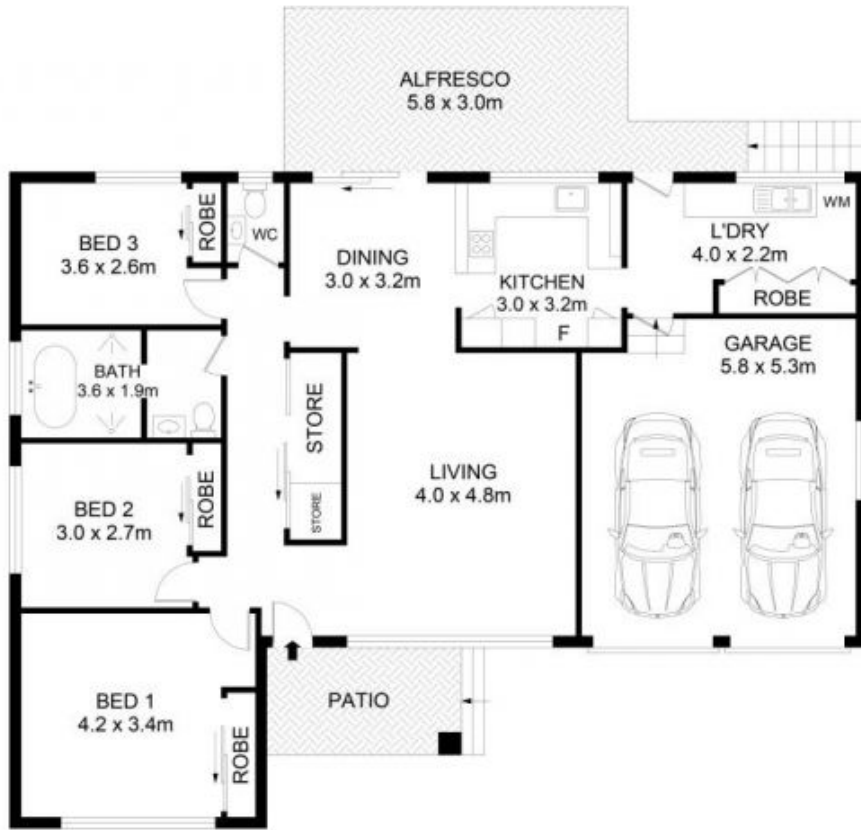

31 Janamba Avenue, Kellyville



Disclaimer

Floor Plan measurements are approximate and are for illustrative purposes only. While we cannot doubt the floor plans accuracy, we make no guarantee, warranty or representation as to the accuracy and completeness of the floor plan

