



2 Greenfield Place Maraylya NSW

4  2  2 

Bordering a peaceful cul-de-sac and boasting two long street frontages, this exceptional acreage property is an enviable opportunity for growing families and horse enthusiasts. An expansive single level home featuring multiple living and entertaining zones is positioned back from the road, with large windows allowing serene acreage views from each room. A formal living zone to the left of the entry is complete with the ambience of a fireplace while an oversized rumpus room is an ideal games room or teenage retreat. The rear sunroom is ideal for entertaining all year round, while a cabana next to the solar heated pool makes gatherings a breeze.

Four well-sized bedrooms make up the formal accommodation of the home, with an additional space inclusive of built-in storage offering potential as a children's playroom or home office. A chic ensuite featuring a bathtub

Price : \$ 2,700,000

View : <https://www.guardianrealty.com.au/sale/nsw/western-sydney/maraylya/residential/acreagesemirural/7186518>



Gavin Weekley
0407 024 600



Josh McAdam
0425 886 484

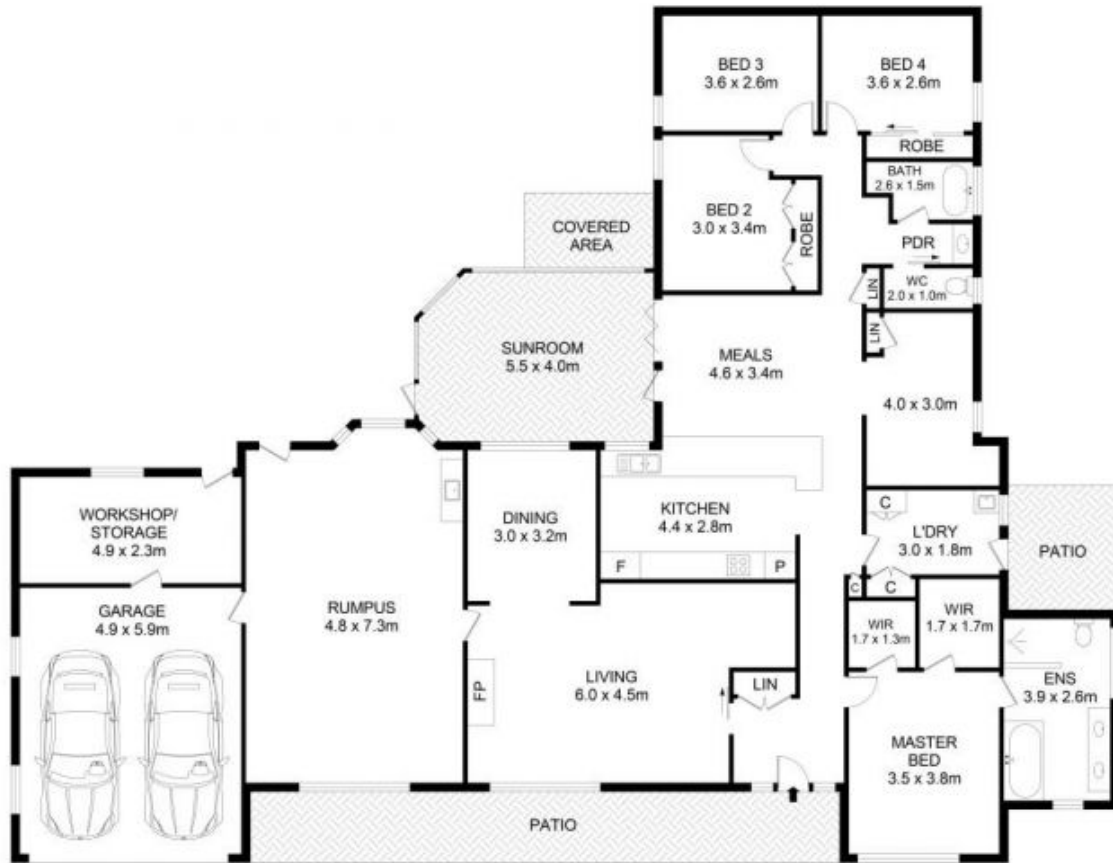

2 Greenfield Place, Maraylya



Disclaimer
Floor Plan measurements are approximate and are for illustrative purposes only. While we cannot doubt the floor plans accuracy, we make no guarantee, warranty or representation as to the accuracy and completeness of the floor plan

guardian
realty