



42 Battlement Crescent Castle Hill NSW

4  2  2 

Conveniently located in the popular Knightsbridge community is this sunny four bedroom home featuring 2 levels of accommodation including a large master bedroom with en-suite and walk-in-robe, 3 other bedrooms with built-ins, a formal lounge and dining, open-plan kitchen with meals area and a large light-filled family room.

External features include a spacious, landscaped gardens and yard with garden shed on slab and a large paved patio area, ideal for entertaining. Situated on approximately 706 square meters in a whisper quiet location close to Samuel Gilbert Primary, public transport and local shopping centre.

Other Features:-

- Ducted Air Conditioning
- Ceiling Fans
- Child friendly landscape gardens

View : <https://www.guardianrealty.com.au/lease/nsw/hills/castle-hill/residential/house/7175949>



Daniel Hall
0448 580 039

42 Battlement Crescent, Castle Hill



FIRST FLOOR

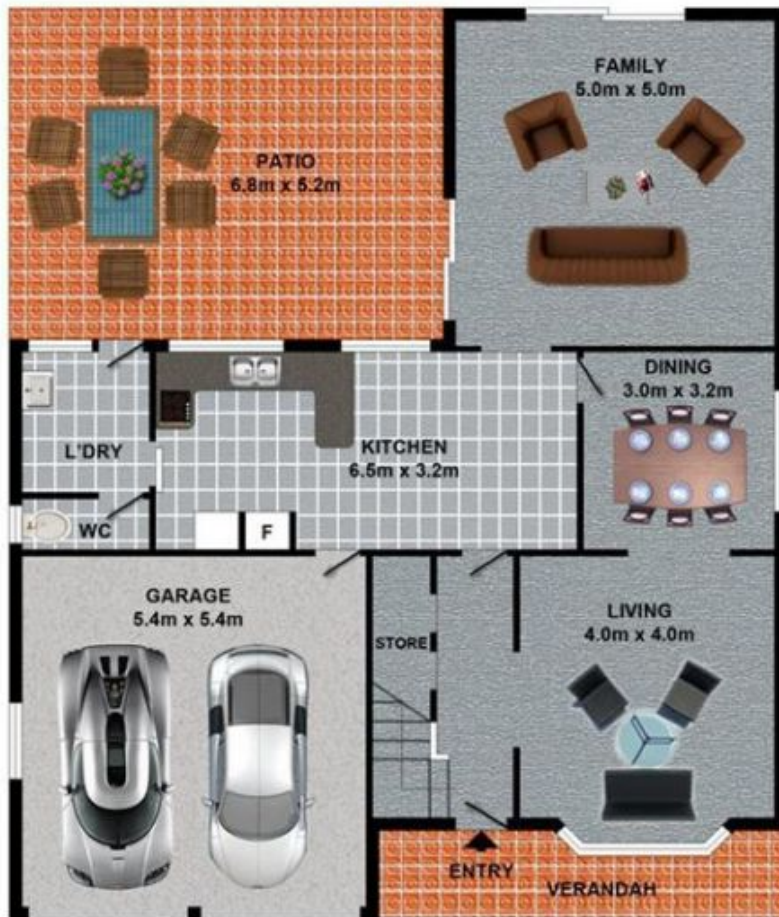

GROUND FLOOR

DISCLAIMER
DIMENSIONS ARE APPROXIMATE AND SHOULD ONLY BE USED AS A GUIDE.
THEY ARE NOT TO SCALE AND NO LIABILITY WILL BE ACCEPTED.