



# guardian



57 First Farm Drive Castle Hill NSW

4 3 2

Occupying a highly-sought position within the prestigious First Farm Estate, this unique residence offers incredible potential for transformation into a dreamy family home. Boasting multiple living zones and a floorplan suited to multi-generational family living, the home is both light-filled and spacious. A large rumpus room includes a built-in bar making it the ideal space for entertaining while the rear sunroom opens to a relaxed alfresco space. An informal meals zone wraps the kitchen which is prime for conversion into a gourmet paradise. The elevated block enjoys a near North-facing aspect, looking to the Blue Mountains and offering unmissable sunset views.

Three well-sized bedrooms with built-in storage are set down a hallway away from the main living zones, with the master suite enjoying the privacy of an ensuite. A generous main bathroom featuring a corner tub serves the remainder

**Price** : \$ 2,226,000  
**Land Size** : 901 sqm  
**View** : <https://www.guardianrealty.com.au/sale/nsw/hills/castle-hill/residential/house/7175215>



**Grant McEnally**  
0414 968 460

<https://www.guardianrealty.com.au>

258 Old Northern Road Castle Hill NSW  
02 9659 5222

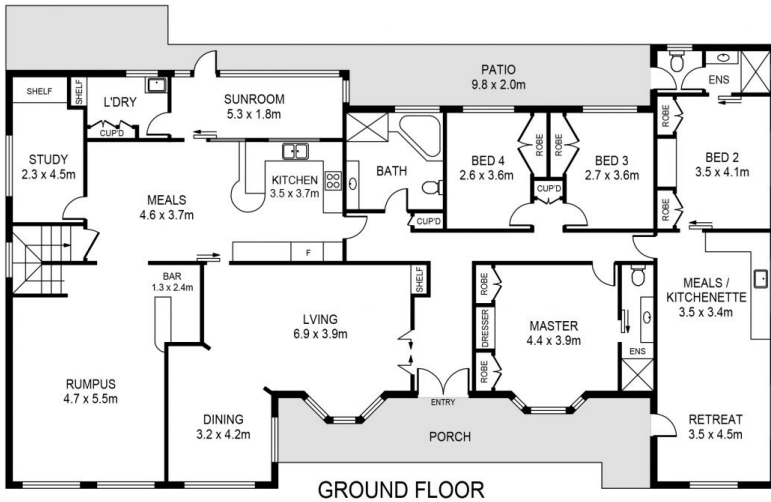

GROUND FLOOR

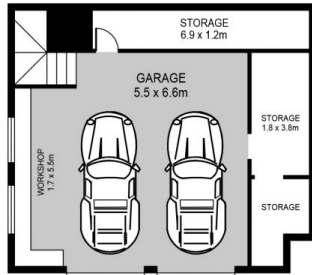

LOWER GROUND FLOOR

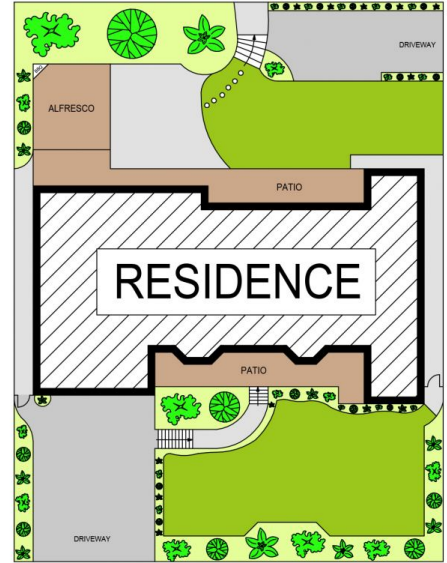

SITE PLAN



57 FIRST FARM DRIVE, CASTLE HILL

DISCLAIMER:

PLANS SHOWN ARE FOR MARKETING PURPOSES ONLY. ALL DIMENSIONS ARE APPROXIMATE AND NOT TO SCALE. THEY ARE SUBJECT TO ERRORS AND INACCURACIES AND NO LIABILITY WILL BE ACCEPTED. INTERESTED PARTIES SHOULD MAKE THEIR OWN INQUIRIES.