



# guardian



## 42 Battlement Crescent Castle Hill NSW

4 2 2

Conveniently located in the popular Knightsbridge community is this sunny four bedroom home featuring 2 levels of accommodation including a large master bedroom with en-suite and walk-in-robe, 3 other bedrooms with built-ins, a formal lounge and dining, open-plan kitchen with meals area and a large light-filled family room.

External features include a spacious, landscaped gardens and yard with garden shed on slab and a large paved patio area, ideal for entertaining. Situated on approximately 706 square meters in a whisper quiet location close to Samuel Gilbert Primary, public transport and local shopping centre.

### Other Features:-

- Ducted Air Conditioning
- Ceiling Fans
- Child friendly landscape gardens

**View :** <https://www.guardianrealty.com.au/lease/nsw/hills/castle-hill/residential/house/6449365>



**Jonathan D'souza**  
0448 580 039

<https://www.guardianrealty.com.au>

534 Old Northern Road Dural NSW  
02 9651 1666

# 42 Battlement Crescent, Castle Hill



FIRST FLOOR

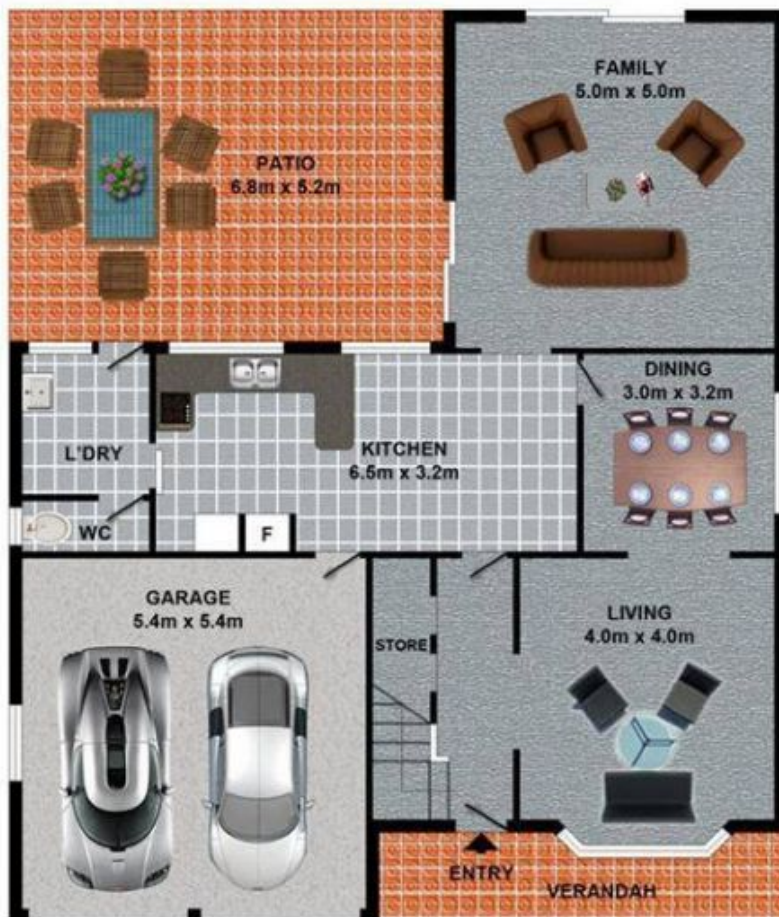

GROUND FLOOR

DISCLAIMER  
DIMENSIONS ARE APPROXIMATE AND SHOULD ONLY BE USED AS A GUIDE.  
THEY ARE NOT TO SCALE AND NO LIABILITY WILL BE ACCEPTED.