



guardian



40 Whitewood Crescent KELLYVILLE RIDGE NSW

4 2 2

Boasting a supremely functional layout providing a perfect balance between airy open plan and segregated living areas, this immaculate Alkira home is ideal for families seeking space on a single level. Stylishly appointed throughout with an emphasis on practicality and easy maintenance, it offers an expansive rumpus and a sleek gas kitchen featuring stainless steel appliances and stone bench tops with waterfall edging overlooking light-filled integrated living and dining zones. Glass doors ensure a smooth transition from indoors to out, with an all-weather pergola offering views over the fully fenced plunge pool and neatly manicured gardens.

Price : \$ 1,030,000
Land Size : 532 sqm
View : <https://www.guardianrealty.com.au/sale/nsw/hills/kellyville-ridge/residential/house/4403526>

- ? Ducted a/c, plantation shutters, intercom
- ? Separate study/kids play room
- ? Built-ins to all bedrooms, master with ensuite
- ? Less than 10 minutes from The Ponds shopping precinct

<https://www.guardianrealty.com.au>

95 Railway Terrace Schofields NSW
02 8889 2211

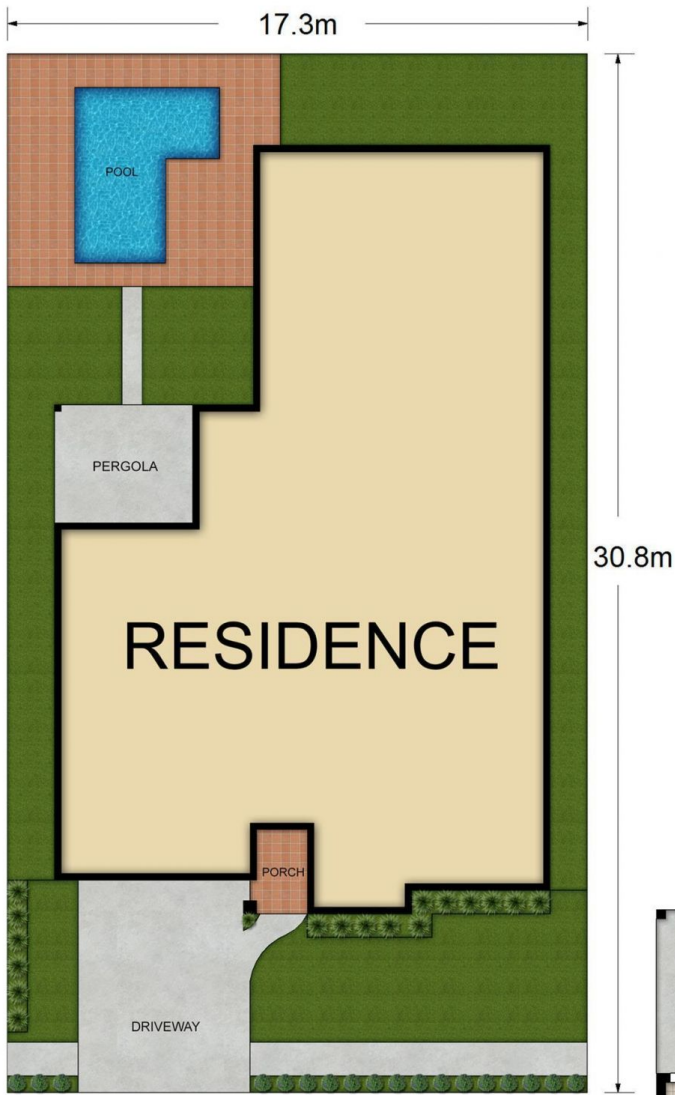

SITE PLAN

